

Engineered by TECHNIMARK®

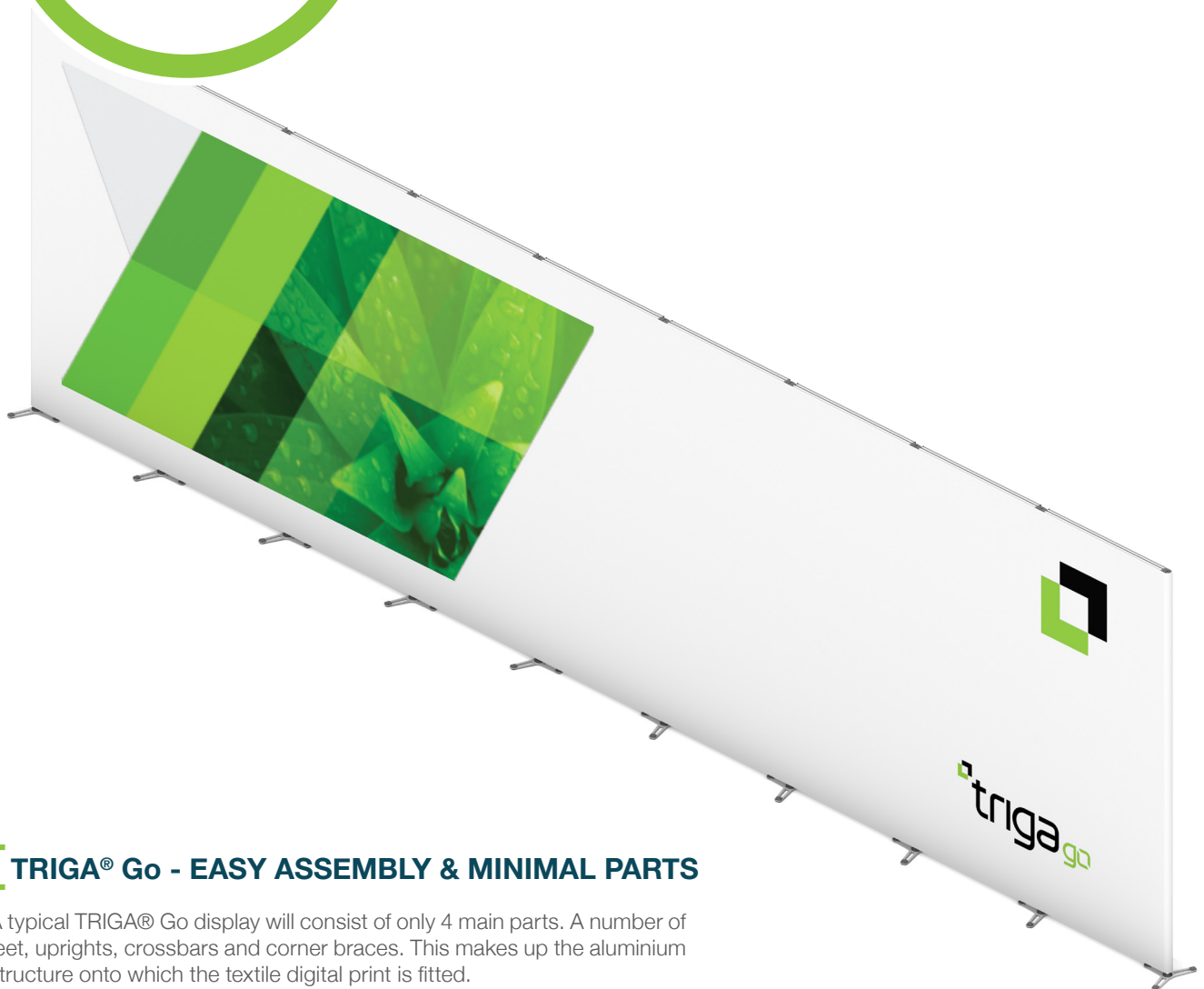

**INNOVATIVE
TENSIONED
TEXTILE
DISPLAYS**

trigago



TRIGA® Go - EASY ASSEMBLY & MINIMAL PARTS

A typical TRIGA® Go display will consist of only 4 main parts. A number of feet, uprights, crossbars and corner braces. This makes up the aluminium structure onto which the textile digital print is fitted.

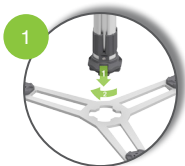

Join poles to foot plate and turn the pole to secure.

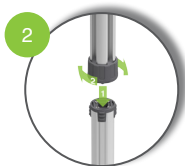

Join the top and bottom poles and turn the connector collar to lock.

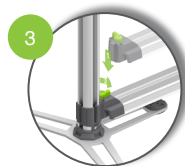

Insert bottom crossbar connector into pole collar and swivel green locking button to secure the crossbar.

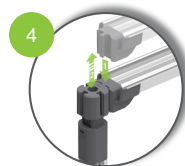

Slot crossbar into tensioner. Once the textile print is fitted, press down on the top of the tensioner to extend it, resulting in wrinkle-free graphics.



The printed textile graphic is fitted with a plastic beading that simply slides into the groove on the crossbar.

IMAGINE | CREATE | DISPLAY



Modular



Durable



Lightweight



Toolless



Scalable



Economical

TRIGA® Go is a quality product, designed to be completely modular, offering unrivalled versatility and savings. It is also exceptionally light and compact, making it the perfect travel companion. It can be reconfigured to create ever changing displays, through MIX and MATCH component options and fresh printed graphics. The textile graphics can be showcased in single or double-sided configurations.

As demonstrated with some of the examples below, a 9m TRIGA® Go Display Wall is so much more...

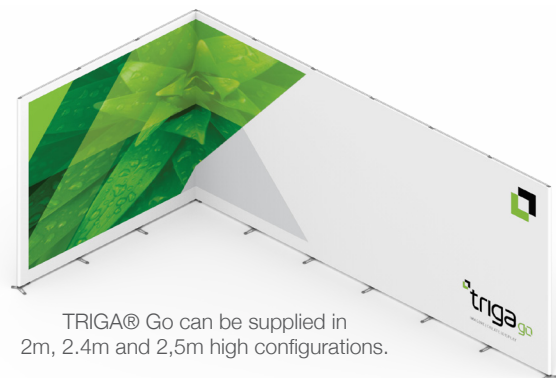

TRIGA® Go can be supplied in 2m, 2.4m and 2.5m high configurations.

3m x 6m L-Booth



One 3m x 3m U-Booth



4m x 4m X-Booth



Three x 2m wide Walls



Two x 1m wide Towers
and One x 2m wide Wall

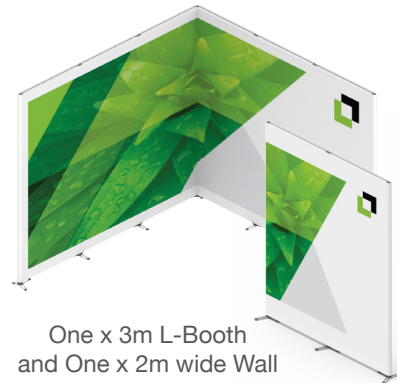

One x 3m L-Booth
and One x 2m wide Wall

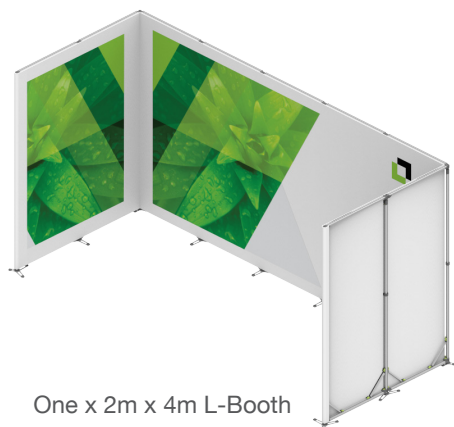

One x 2m x 4m L-Booth

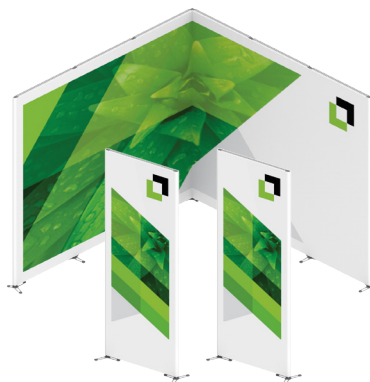

One x 3m L-Booth and
Two x 1m wide Totems

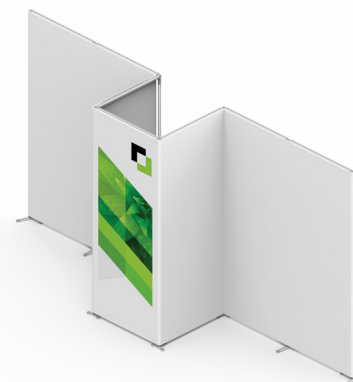

4m x 1m Shaped booth with
90deg angles

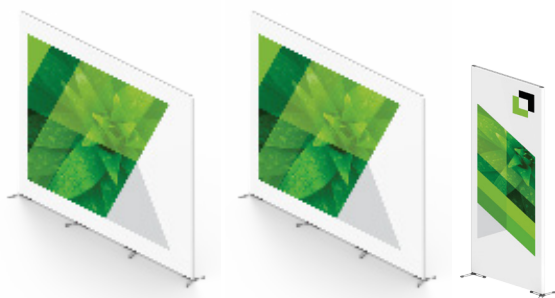

Two x 3m wide Walls and One x 1m Totem



One x 3m wide Wall, One x 1m wide Tower and
One x 1m wide Totem